

Windmill Generator

A. SAFETY WARNINGS

1. Before you start, please read through all the instructions.
2. This kit is intended for children over 8.
3. Adult assistance and supervision is recommended at all times.
4. Both the kit and the completed wind generator contain small parts that may cause choking if misused. Keep away from children under 3 years old.
5. You are advised to wear eye protection and gloves when the wind generator is working, as strong winds may cause parts to fly off.

B. BEFORE YOU START

To complete the wind generator you will need a clean plastic drinks bottle and use a small cross-head screwdriver – these are NOT included. Carefully identify all the following parts before you begin to assemble your wind generator:

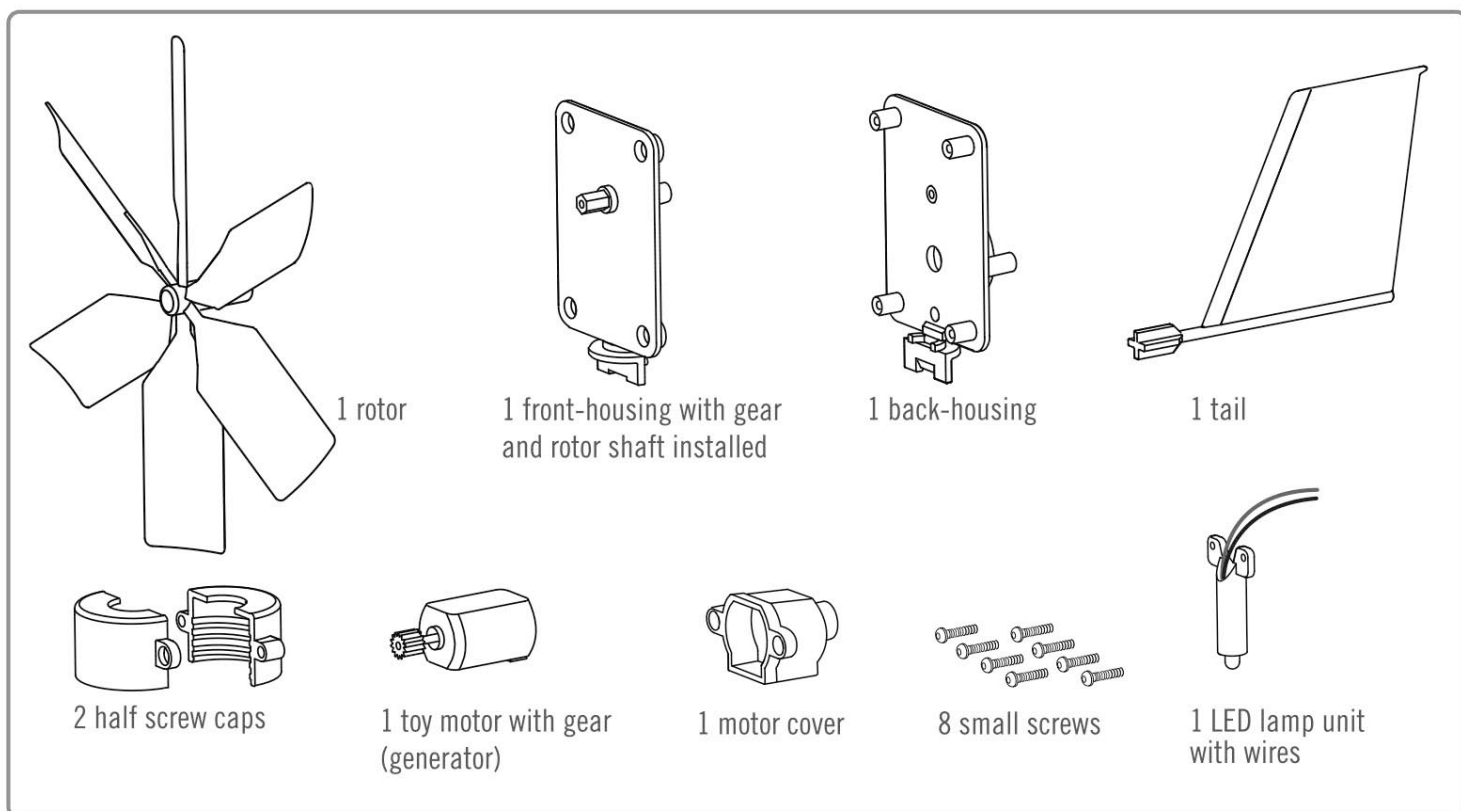

C. CONTENTS

1 rotor, 1 front housing, 1 back housing, 2 half screw caps, 1 tail, 1 rotor shaft, 1 toy motor with gear (generator), 1 motor cover, 8 small screws, 1 LED unit with wires, 1 gear with metal shaft.

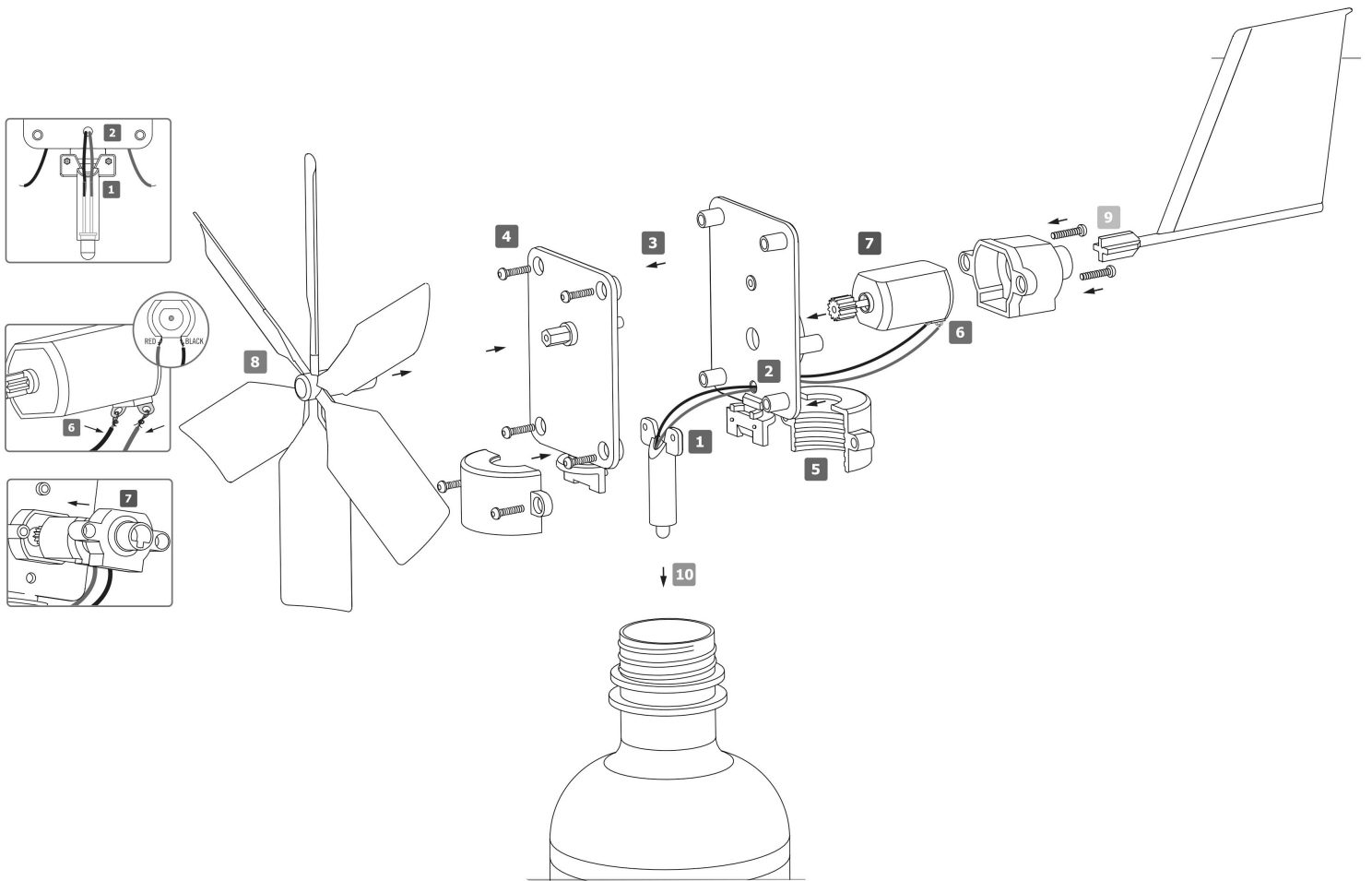

D. ASSEMBLY

ASSEMBLING THE HOUSING

1. Fix the LED unit to the lower part of the front housing.
2. Thread the wires through the bottom hole in the back housing.
3. Push the two halves of the housing together.
4. Secure them with four screws.
5. Assemble the two half screw caps around the lower part of the housing, and secure them with two screws. Put a little cooking oil on the top of the caps to help the housing turn freely.

CONNECTING THE WIRES

6. Connect the red wire and black wire to the metal tags on the motor as shown opposite. The LED will not work if they are connected the other way round. With the plastic base of the motor facing you and the metal tags facing down, the red wire should be at your left and the black wire at your right. Thread the bare end of each wire through the hole in its tag, bend it over and gently twist it to secure it.

INSTALLING THE MOTOR

7. Insert the gear end of the motor into the housing as shown. Gently press it into place so that the teeth on the gear wheels interlock. Add the motor cover and secure with two screws.

ADDING THE ROTOR

8. Push the rotor onto the rotor shaft.

ADDING THE TAIL

9. Push the tail into the hole in the back of the motor cover.

ADDING THE STAND

10. The screw cap will fit most 1-litre drinks bottles. Recycle a bottle by emptying and cleaning it, and screw the screw cap onto it. Your wind generator is now complete.

MOTOR

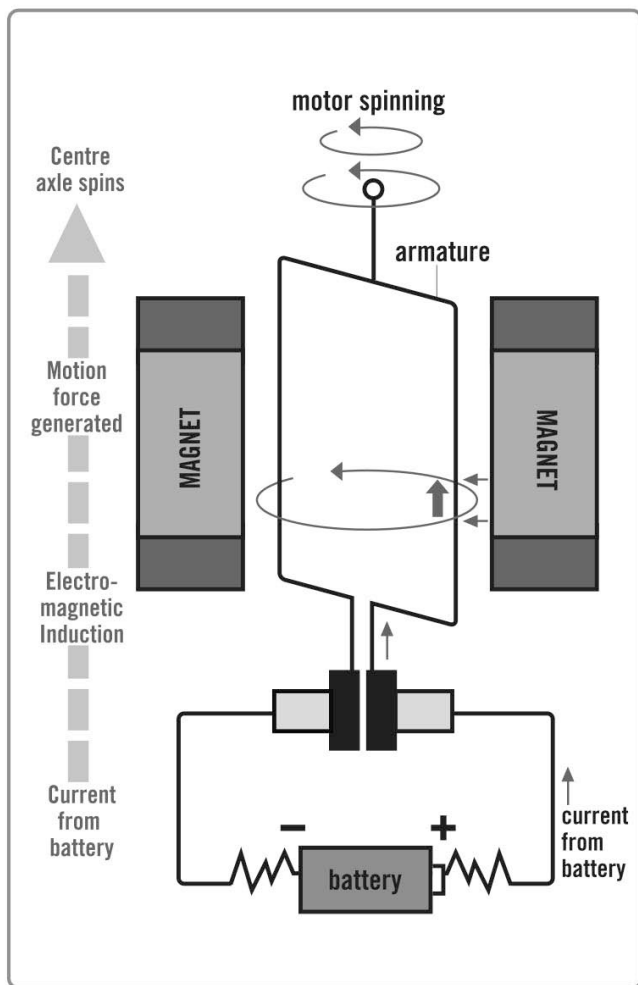

WINDMILL GENERATOR

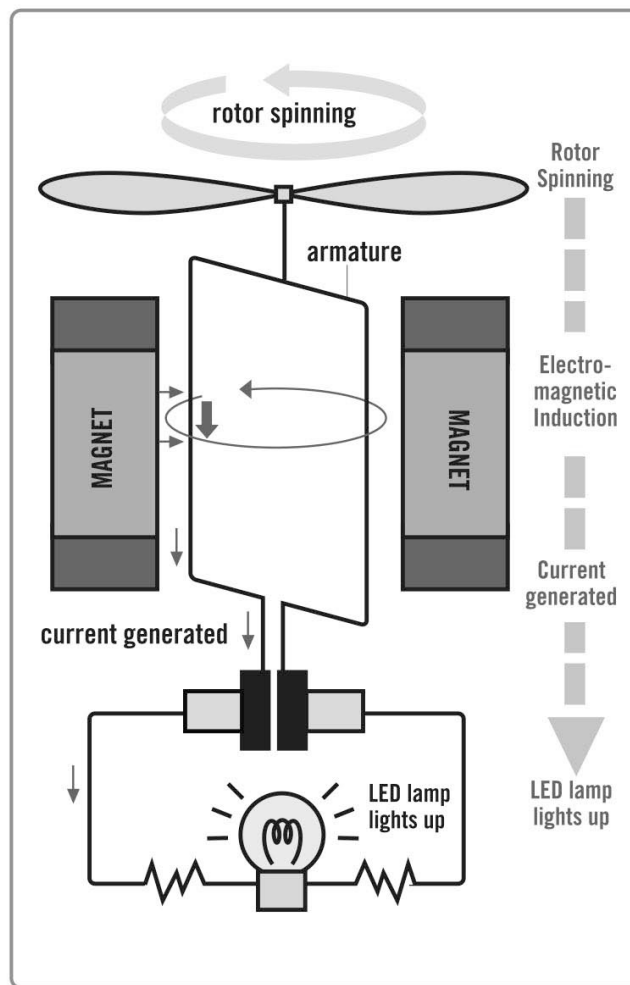

E . HOW TO USE YOUR WIND GENERATOR

Hold the plastic bottle vertically in one hand and point the rotor into the wind. Alternatively, half fill the bottle with water to make it stable, and stand the generator on the ground (be careful not to let water touch the LED). The wind generator needs a strong wind (about 15 to 20 kilometres per hour) before the rotor will turn the generator fast enough to produce sufficient electricity to operate the LED. If you are working outdoors, it will be more windy in an open space, on a hill, or at the beach. If you are working indoors (for example, in a classroom), you will need to use a mains-powered electric fan on a medium or high setting to produce enough wind. Adult supervision is need when using the electric fan.

Note: The wind generator is designed for occasional demonstration purposes only. If you would like to install it permanently outdoors, you should be aware that strong winds and rain could damage its parts.

More fun: Try putting your wind generator outside at night, and watch the LED light up when the wind blows. Add water to the bottle to see a water light show. Remember to bring the generator back indoors afterwards, and be careful that water does not touch the LED. Customise your wind generator by adding coloured stickers to the plastic bottle and the tail.

F . TROUBLE SHOOTING

Follow these steps if the LED does not light up.

- The rotor may not be spinning fast enough. Wait for a stronger wind, or move to a windier place, or if indoors, use a higher fan speed. You can also add a little grease to the gear teeth to make them turn more easily.
- Check also if the base of the rotor shaft touching the surface of the front housing. This will create friction and stop the rotor from spinning smoothly. Slightly lift the rotor shaft so that it no longer touches the housing (see step 1).
- Check that the wires are connected properly to the motor, and that the red and black wires are connected the correct way round (see step 6).
- Check that the housing can turn freely on the screw cap. The rotor will not turn at full speed unless it faces directly into the wind.

G. HOW DOES THE GENERATOR WORK?

Your wind generator turns the energy in the wind into light that comes from the LED (light-emitting diode). The wind pushes on the rotor blades, making the rotor turn, always in the same direction. The stronger the wind, the faster the rotor turns. The gear wheels make the shaft of the motor turn many times for each turn of the rotor. The motor actually works as a generator. Inside the motor is an armature attached to the shaft. The armature has hundreds of turns of wire around it. Around the armature are permanent magnets. When electricity is fed into a motor, it flows through the armature, turning it into an electromagnet. The armature is repelled and attracted by the permanent magnets, making it spin. In your wind generator, the motor works in reverse. When the armature is spun round by the shaft, the magnetic field made by the permanent magnets causes electricity to flow in the wire in the armature. When the shaft is turned fast enough, the electricity generated is strong enough to make the LED light up. The wind generator's tail keeps the rotor facing into the wind.

H. FUN FACTS

- The most powerful wind generator in the world is the REpower 5M. Each of its three blades is 61.6 metres long. It produces enough electricity for 5,000 houses.
- A small wind generator can supply enough electricity for a home, school or small factory.
- The world's largest wind farm is the Horse Hollow Wind Energy Center in Texas, USA. It has a total of 421 generators. It will produce 735 megawatts of power, enough to boil half a million kettles at once.
- Offshore wind farms are wind farms built at sea, where the wind is more consistent in strength and direction. The wind generators sit on pylons resting on the sea bed.
- Engineers are designing and testing airborne wind generators. These will float thousands of metres above the ground, where strong winds nearly always blow.
- Wind generators are a clean and renewable way of producing energy. But they are useless when the wind stops blowing! So we need other forms of renewable energy, too.
- Ocean turbines are like wind generators under the sea. They capture the energy in the currents caused by rising and falling tides.
- Plastic drinks bottles like the one you recycled for the wind generator are normally made from a type of plastic called PET (short for polyethylene terephthalate).
- PET bottles are recycled to make hundreds of different objects, such as new bottles, packaging film and fibres for making carpets and clothes.
- The recycled plastic from just 25 drinks bottles can be made into a warm fleece jacket!

QUESTIONS & COMMENTS

We treasure you as a customer and your satisfaction with this product is important to us. In case you have any comments or questions, or you find any parts of this kit missing or defective, please do not hesitate to contact our distributor in your country, whose address is printed on the package. You are also welcome to contact our marketing support team at Email: infodesk@4M-IND.com, Fax (852) 25911566, Tel (852) 28936241, Web site: WWW.4M-IND.COM